

Apartment (EPC Rating: C)

FLAT 141, CALENDULA DONALD HALL ROAD, BRIGHTON, BN2 5DN

£1,600

**ASTON
VAUGHAN**
Sales and Lettings



2 Bedroom Apartment located in Brighton

The property features a spacious reception room, perfect for relaxing or entertaining guests, while the two well-proportioned bedrooms provide ample space for comfortable living. The bathroom is modern and well-maintained, ensuring convenience for daily routines. This unfurnished flat is available for rent and is ready for you to make it your own.

One of the standout features of this apartment is the stunning sea views, which can be enjoyed from various vantage points within the home. The property is in good modern condition throughout, making it an ideal choice for those who appreciate contemporary living.

Built in 1965, this apartment combines classic charm with modern amenities, providing a welcoming atmosphere for its residents. With its prime location in Brighton, you will find yourself just moments away from the vibrant local culture, shops, and, of course, the Sussex County Hospital and beautiful beach.

This property is available now, offering you the chance to embrace a new lifestyle in one of the UK's most sought-after coastal cities. Don't miss out on this fantastic opportunity to secure a lovely home with breathtaking views.



Donald Hall Road

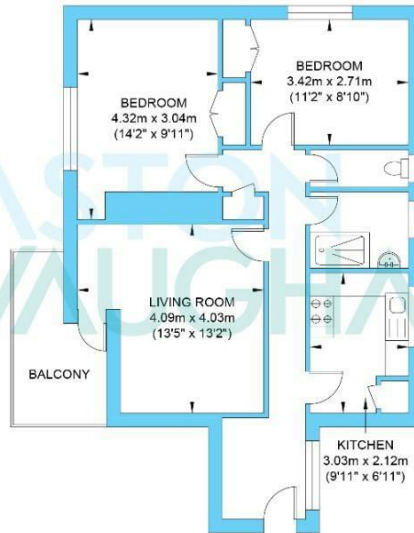

Fifth Floor Flat
Approximate Floor Area
677.05 sq ft
(62.90 sq m)

Approximate Gross Internal Area = 62.90 sq m / 677.05 sq ft

Illustration for identification purposes only, measurements are approximate, not to scale.

Council Tax Band

C

Energy Performance Graph

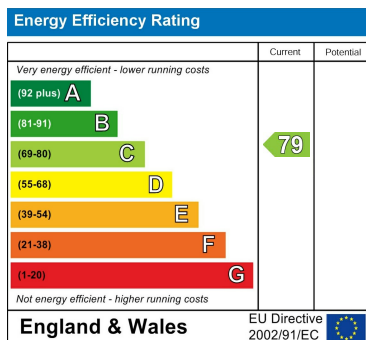

Call us on

01273 253000

info@astonvaughan.co.uk

www.astonvaughan.co.uk

Agents Note: Whilst every care has been taken to prepare these particulars, they are for guidance purposes only. All measurements are approximate and are for general guidance purposes only and whilst every care has been taken to ensure their accuracy, they should not be relied upon and potential buyers are advised to recheck the measurements.